

February 27, 2006

Mr. Brian Lavery, P.E.
Continental Consulting Engineers, Inc.
9000 State Line Road
Leawood, Kansas 66206

CONTINENTAL
CONSULTING
ENGINEERS, INC.

FEB 28 2006

Re: The Villaggio at Leawood Sanitary Service – East area

Dear Mr. Lavery –

We have reviewed the service areas in the vicinity of 135th and Mission. The 30.29 acres shown on your attached map for Villaggio may be served to manhole BRM1(32)014 or BRM1(32)013 at your discretion.

If you have any other questions, please let us know.

Sincerely,



Jennifer Harder, P.E.
Senior Development Engineer

Enclosure

cc: Matt Ridpath, Engineering Technician

VillaggioEastService2-06



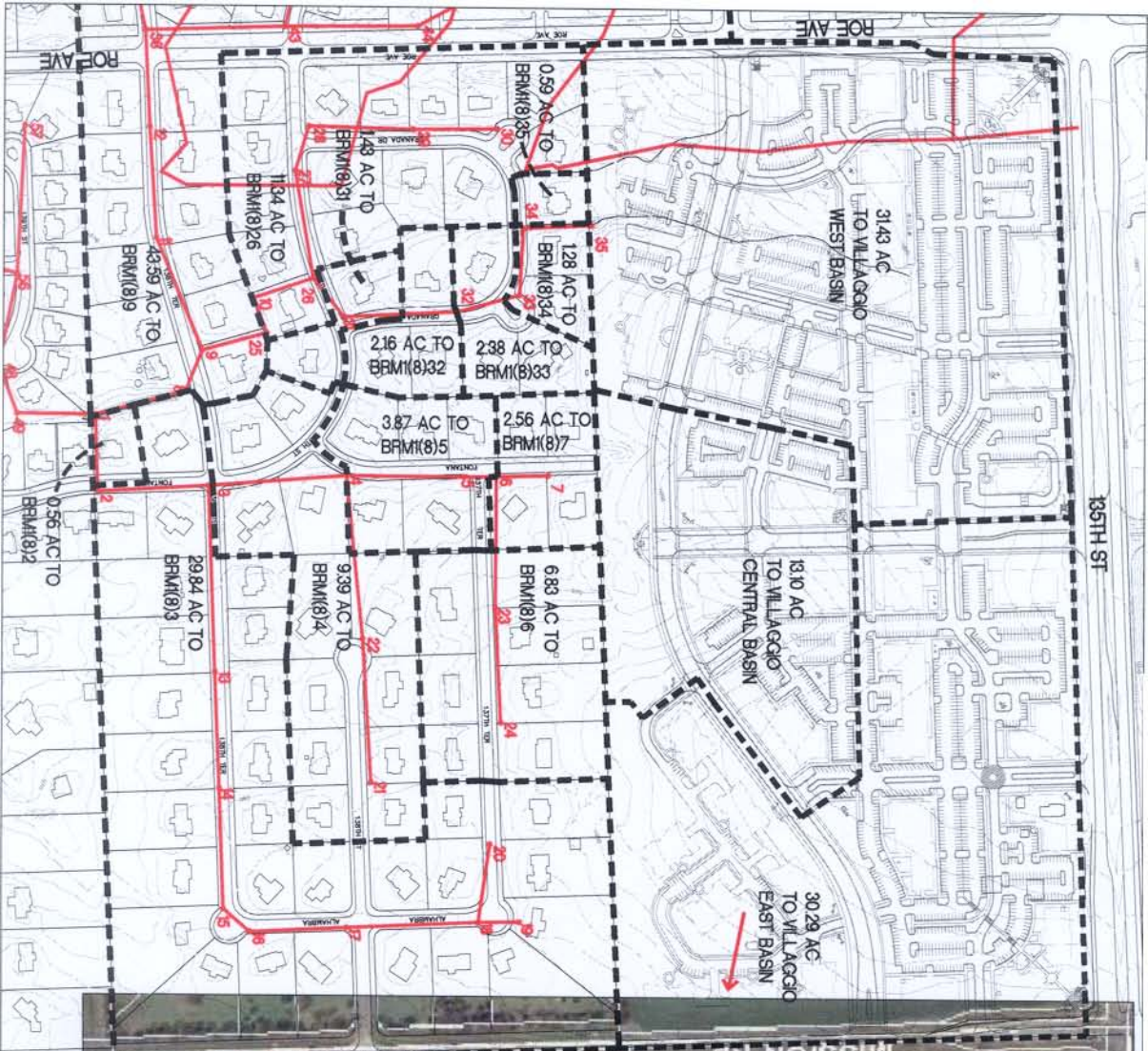

VILLAGGIO AT LEAWOOD
SANITARY SERVICE MAP